

5405-274 AI

ASSEMBLY INSTRUCTION

Page
1/2

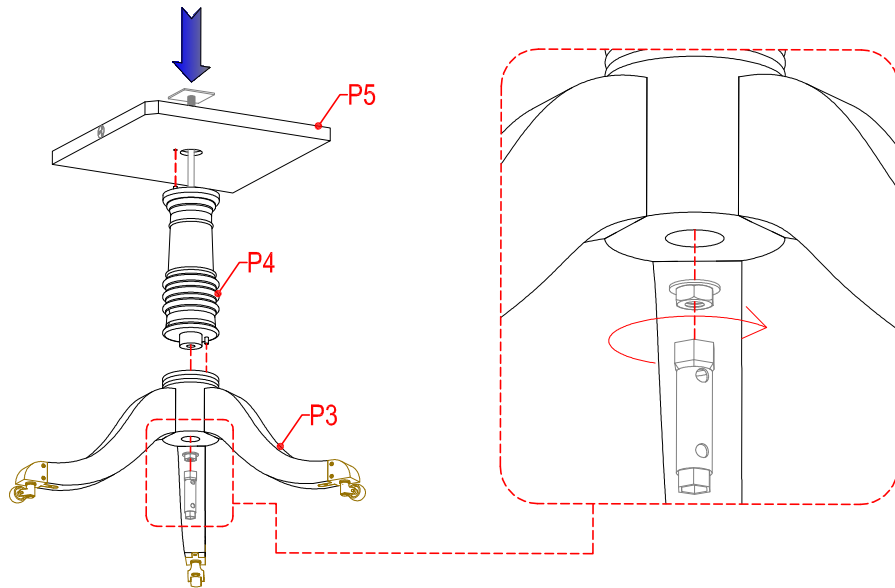

PACKING LIST:

ITEM PARTS	Q'ty	U/M
P1. Top	1	Pc
P2. Leaf	1	Pc
P3. Leg	1	Pc
P4. Center post	1	Pc
P5. Support top	1	Pc
HARD WARE		
Steel threaded bar with nut & washer	1	Pc
Steel allen bolt & washer	4	Pcs
Steel open wrench (tube)	1	Pc
Steel allen open wrench	1	Pc

INSTRUCTIONS :

1. Insert the steel threaded bar to the support top (P5), center post (P4) and leg (P3), then insert steel hexagonal nut & washer, use steel open wrench (tube) to turn clockwise direction securely. Refer detail A
2. Assemble the top (P1) to the base, then insert steel allen bolt & washer, use steel open allen wrench to turn clockwise direction securely. Refer detail 'B'
3. Item is ready to use.

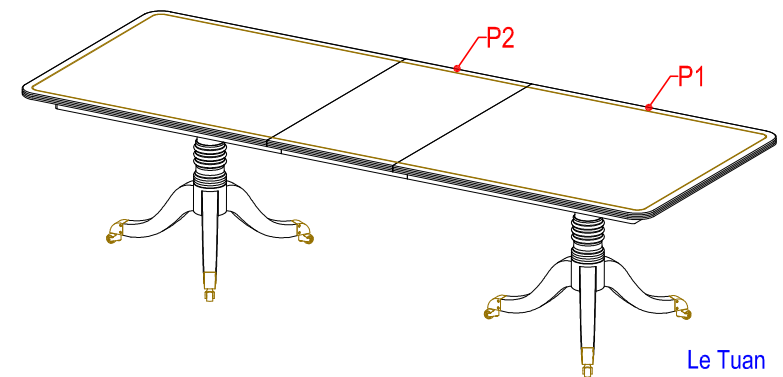
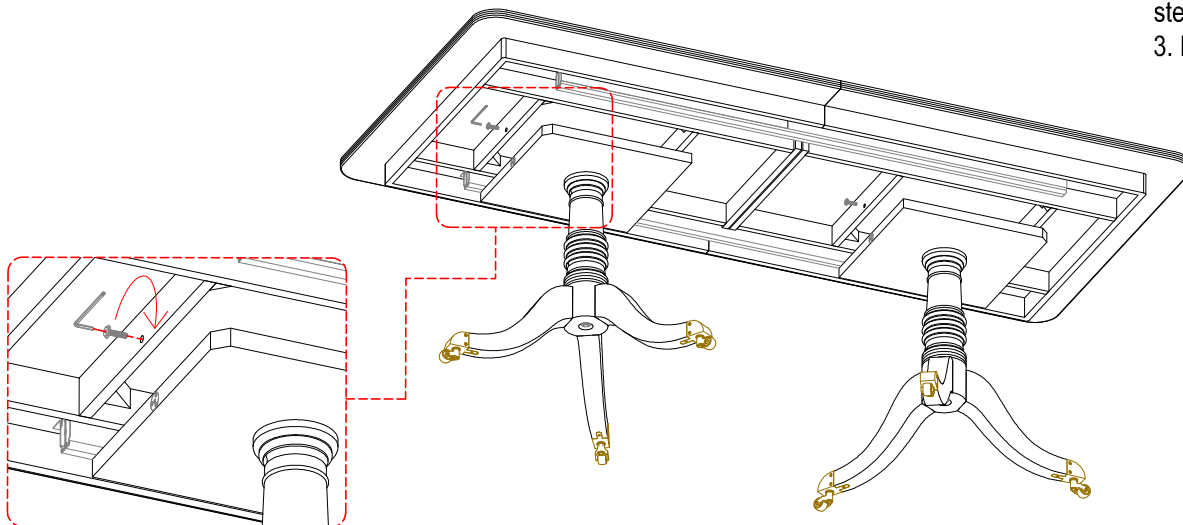

Le Tuan
6-Dec-14

5405-274 AI

ASSEMBLY INSTRUCTION

Page
1/2

WHEN OPEN LEAF

- Open the lock of top panel (P1) see **detail 'C'**, then open the top panel arrow guide. **Refer sketch 1.**
- Put the leaf panel (P2) to the top panel as per **sketch 2**, then close the top panel arrow guide and close the lock. **Refer detail 'D'**

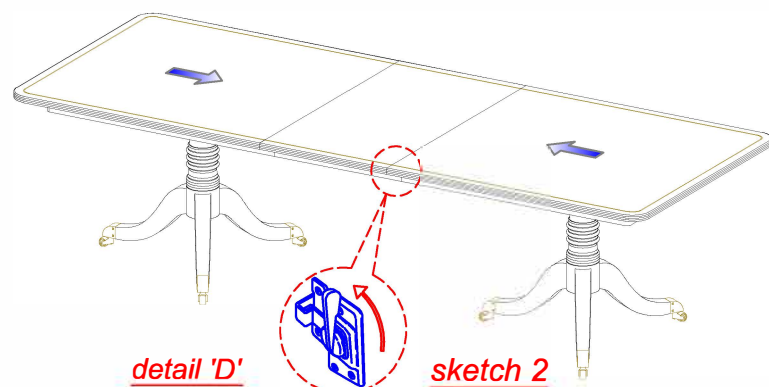
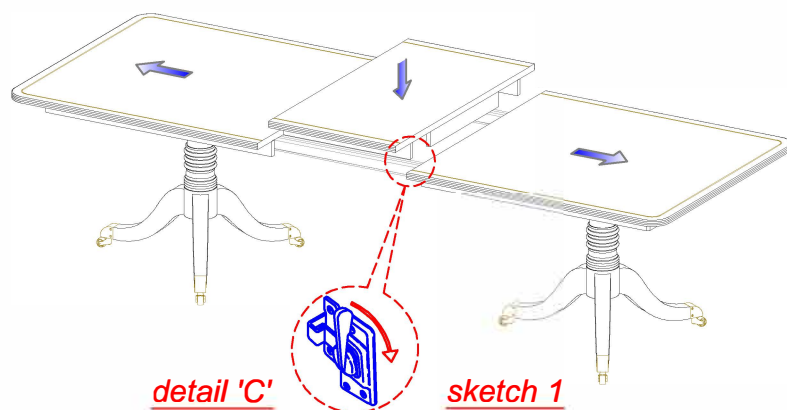

WHEN CLOSE LEAF

- Open the lock of top panel (P1) and the leaf (P2) see **detail 'E'**, then open the top panel arrow guide. **Refer sketch 3.**
- Remove the leaf panel (P2) out the top panel as per **sketch 4**, then close the top panel arrow guide and close the lock. **Refer detail 'F'**

