

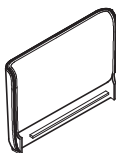
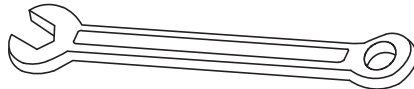
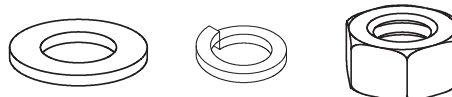
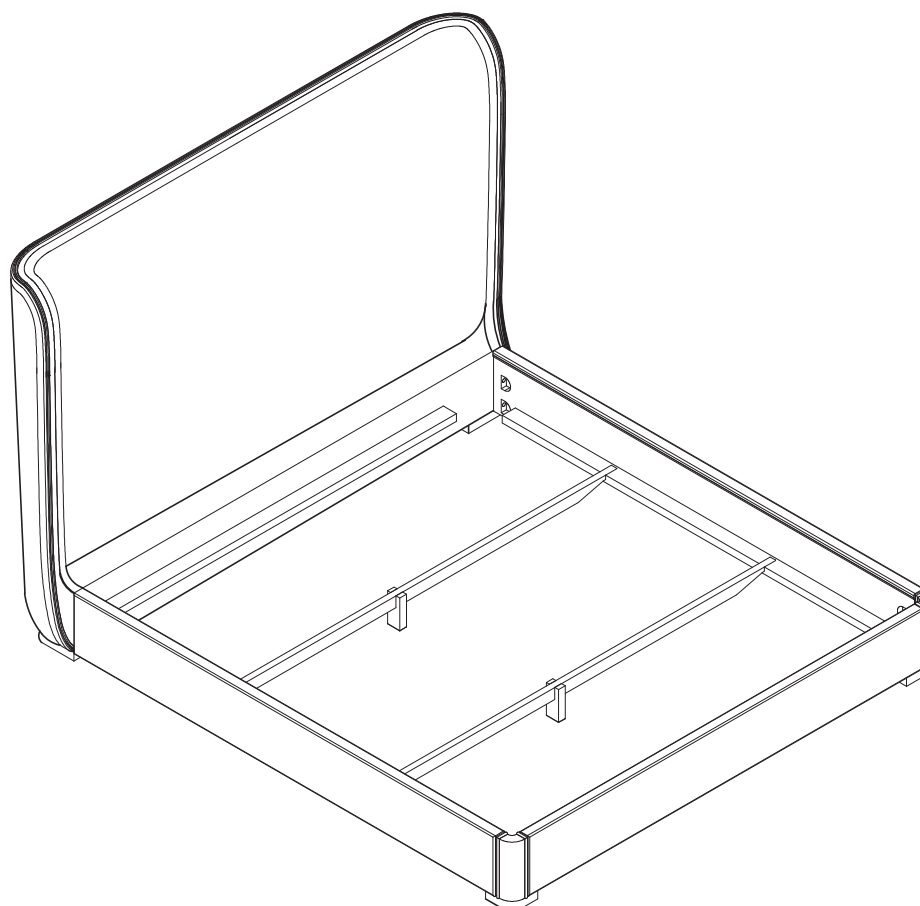
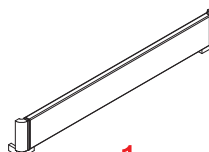
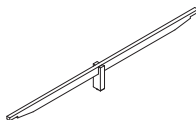
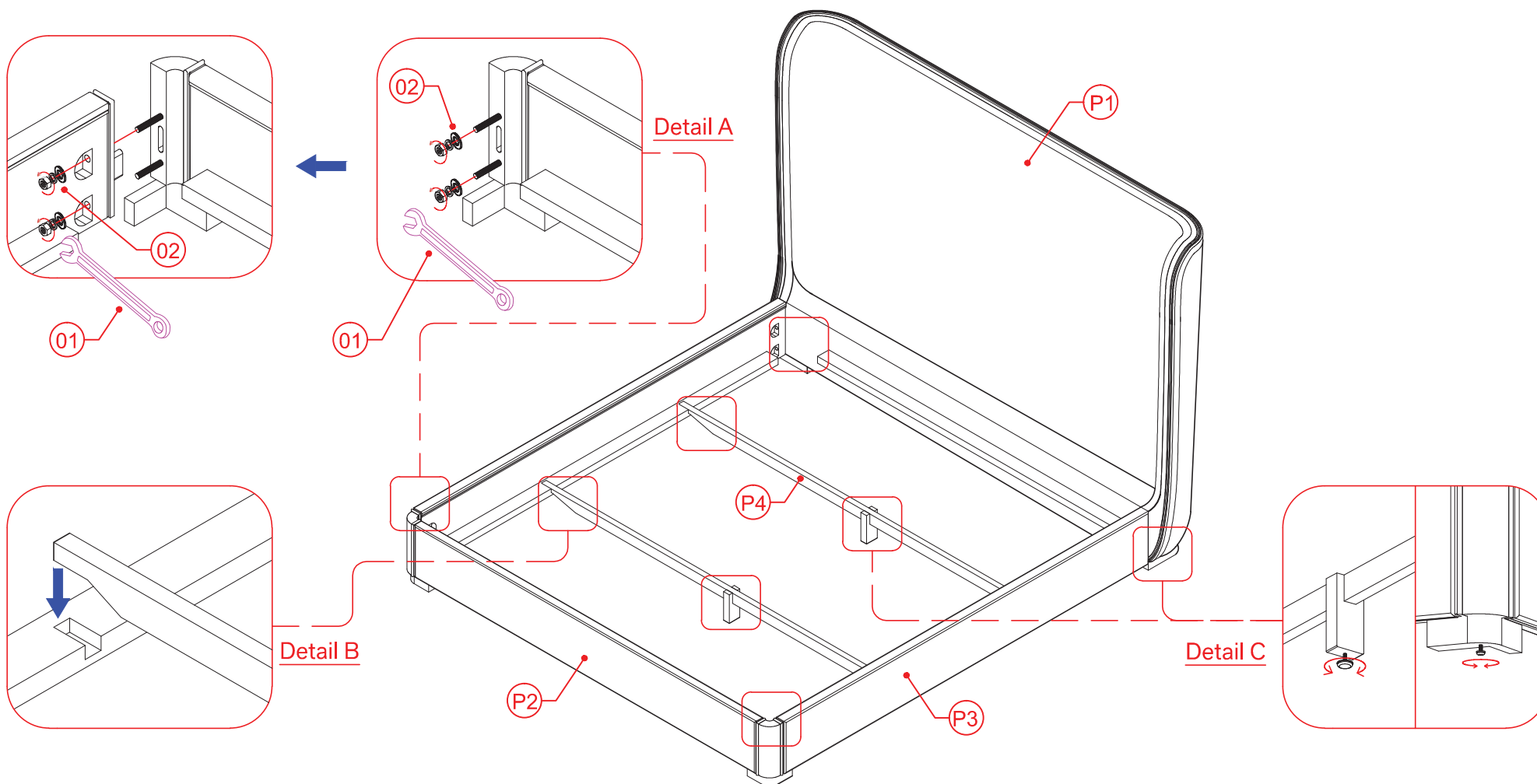

P1	Headboard	1	Steel open wrench	2	Hexagonal nut, washer & lock washer
 x 1		 x 1		 x 8	
P2	Footboard				
 x 1					
P3	Side Rails				
 x 2					
P4	Center Supports				
 x 2					

Date: 10-Dec-2019

**INSTRUCTIONS :**

1. Remove all the hexagonal nuts & washers (2) out of the steel threaded on headboard (P1) and footboard (P2). Then assemble the side rails (P3) to the headboard (P1) and footboard (P2), insert washers, lock washers & hexagonal nuts , (2) , use steel open wrench (1) to turn clockwise direction securely, refer detail 'A'.
3. Insert the center support (P4) to the pre-cut slots on side rails. Refer detail 'B'.
4. Adjust glider for levelling the center support and the legs if necessary. Refer detail 'C'.
6. Item is ready to use.